



3 Bed House

located in
Woodfield Road,
Doncaster

Offers Over £100,000



Moss
PROPERTIES

DIRECTIONS

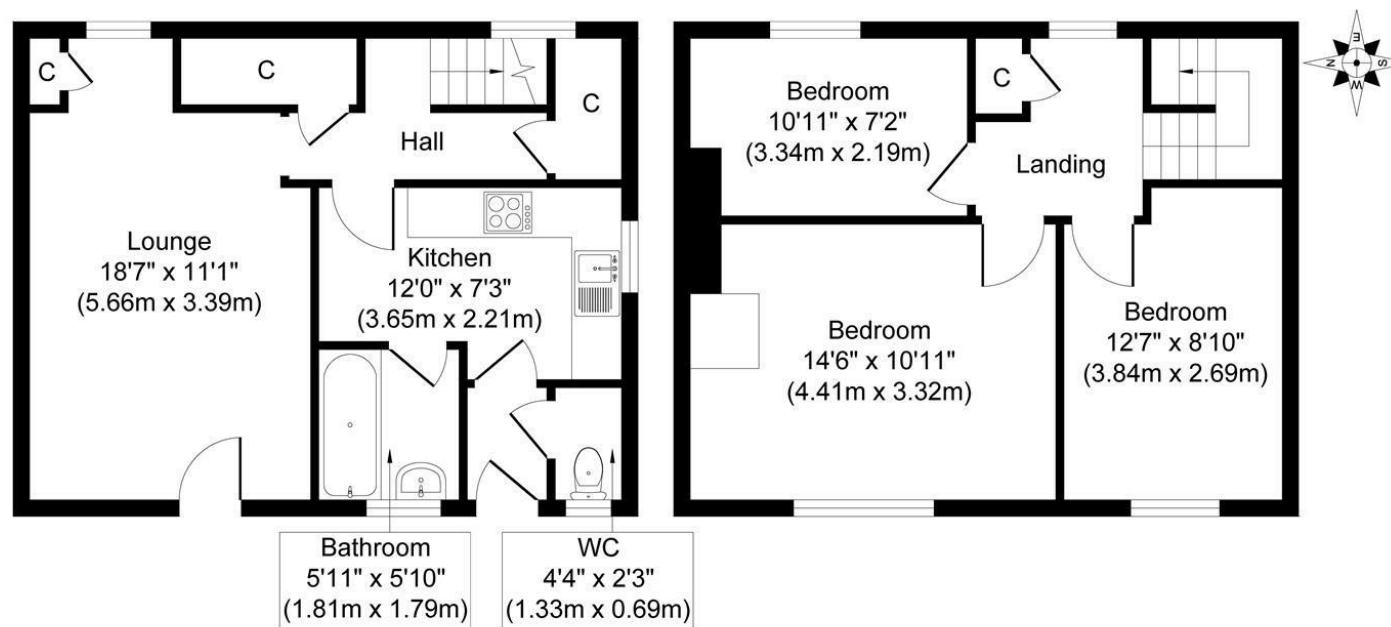

Ground Floor
Approximate Floor Area
427 sq. ft
(39.69 sq. m)

First Floor
Approximate Floor Area
427 sq. ft
(39.69 sq. m)

Whilst every attempt has been made to ensure the accuracy of the floor plan contained here, measurements of doors, windows, rooms and any other items are approximate and no responsibility is taken for any error, omission, or mis-statement. The measurements should not be relied upon for valuation, transaction and/or funding purposes. This plan is for illustrative purposes only and should be used as such by any prospective purchaser or tenant. The services, systems and appliances shown have not been tested and no guarantee as to their operability or efficiency can be given.

Copyright V360 Ltd 2025 | www.houseviz.com

CONTACT

White Rose Way
Doncaster
South Yorkshire

E: info@mossspm.co.uk
T: 01302 730077
www.mossspm.co.uk

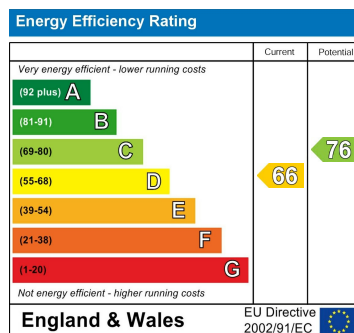

Moss
PROPERTIES